

# Public Document Pack

## Witney Town Council

Mrs Sharon Groth FSLCC fCMgr  
Town Clerk

Cllr Duncan Enright  
Mayor of Witney



Town Hall, Market Square  
Witney, Oxon  
OX28 6AG  
Tel: 01993 704379  
Fax: 01993 771893  
E-mail: [info@witney-tc.gov.uk](mailto:info@witney-tc.gov.uk)  
[www.witney-tc.gov.uk](http://www.witney-tc.gov.uk)

11 December 2019

To: Members of the Planning and Development - *R Smith, J Aitman, L Ashbourne, T Ashby, V Gwatkin, M Jones, A McMahon and A Prosser (and all other Town Councillors for information)*

You are hereby summonsed to a Meeting of the **Planning and Development** to be held in the Council Chamber, Town Hall on **Tuesday, 17th December, 2019 at 6.00 pm** for the transaction of the business stated below.

### RECORDING OF MEETINGS

Under the Openness of Local Government Bodies Regulations 2014 the council's public meetings may be recorded, which includes filming, audio-recording as well as photography. As a matter of courtesy, if you intend to record any part of the proceedings please let the Town Clerk or Democratic Services Officer know before the start of the meeting.

### AGENDA

*All Council Meetings are open to the public and press, unless otherwise stated.*

1. **Apologies for Absence**

To consider apologies and reasons for absence.

Committee Members who are unable to attend the meeting should notify the Democratic Services Officer ([nicky.cayley@witney-tc.gov.uk](mailto:nicky.cayley@witney-tc.gov.uk)) prior to the meeting, stating the reason for absence.

**Standing Order 30(a)(v)** permits the appointment of substitute Councillors to a Committee whose role is to replace ordinary Councillors at a meeting of a Committee if ordinary Councillors of the Committee have confirmed to the Proper Officer **before** the meeting that they are unable to attend.

2. **Declarations of Interest**

Members are reminded to declare any disclosable pecuniary interests in any of the items under consideration at this meeting in accordance with the Town Council's code of conduct.

3. **Public Participation**

***The meeting will adjourn for this item***

Members of the public may speak for a maximum of **five minutes** each during the period of public participation, in line with Standing Order 42. Matters raised shall relate to the following items on the agenda.

4. **Planning Applications** (Pages 3 - 4)

To receive and consider planning applications from West Oxfordshire District Council, as per schedule.

5. **CONSULTATION – A415 Ducklington Lane (Witney) - Proposed 30mph Speed Limit extension and Prohibition of Vehicles** (Pages 5 - 18)

To receive and consider a consultation from Oxfordshire County Council.



Town Clerk



4.5 **WTC/204/19** Plot Ref :- 19/03335/SCOP Type :- SCOPE  
Applicant Name :- MAWLE TRUSTEE & TRUSTEES OF BARNOR Received :- 09/12/2019  
Parish :- EAST Date Returned :-  
Location :- LAND SOUTH EAST OF Agent  
OXFORD HIL  
OXFORD HILL  
WITNEY  
Proposals :- Scoping opinion in relation to a proposed planning application for  
a residential development.  
Observations :-

---

4.6 **WTC/205/19** Plot Ref :- 19/02624/FUL Type :- FULL  
Applicant Name :- HEAST, MR DALE Date Received :- 09/12/2019  
Parish :- WEST Date Returned :-  
Location :- 43 VALENCE Agent  
CRESCENT  
WITNEY  
OXON  
Proposals :- Change of use of land to extend domestic garden, construction of  
new boundary fencing and erection of outbuilding for use as home  
office/gym (Retrospective).  
Observations :-

---

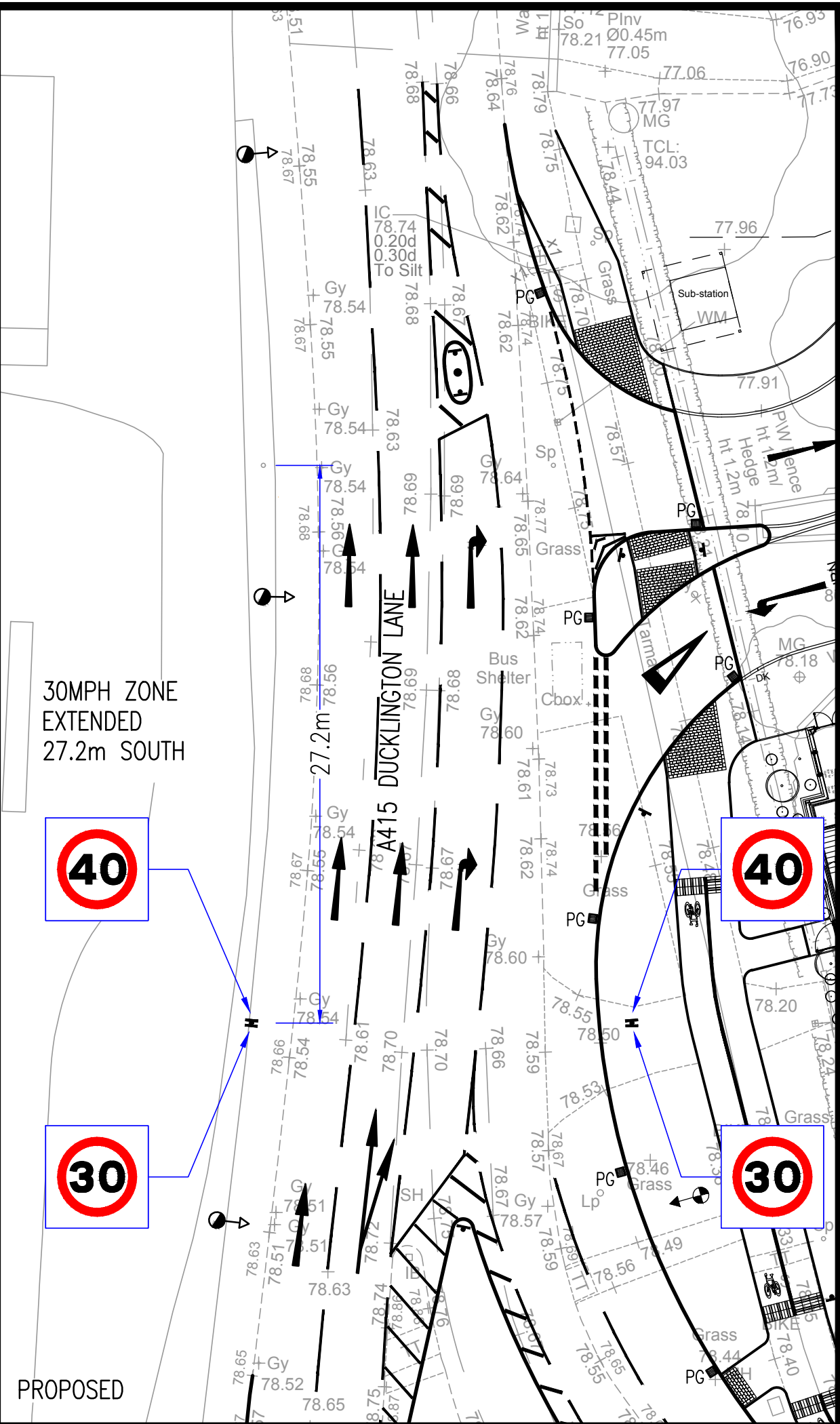
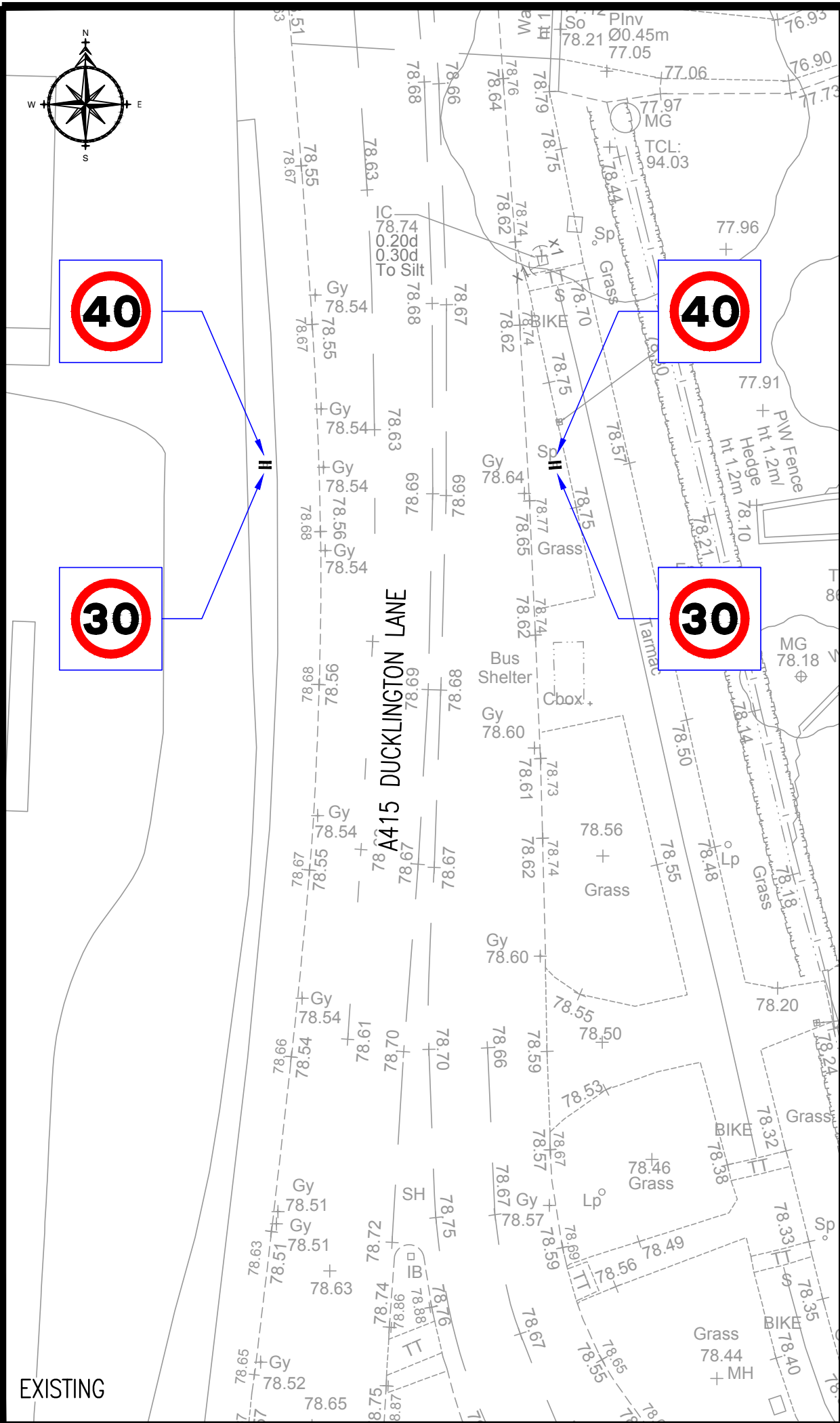

- © Copyright ADL Traffic & Highways Engineering Ltd  
NOTES
1. Do not scale from this drawing
  2. All details to be confirmed on site.
  3. Background plan is based upon a topographical survey supplied by greenhatch group and architects site plan supplied by DDP.
- Drawing No. 191 - 100 Rev. A.

Rev	Description	Date	By	Chk

AMENDMENTS



ADL Traffic & Highways Engineering Ltd.  
ADL House  
The Oaklands Business Park  
Yate, Bristol  
BS37 5NA  
Tel : 01454 332100  
Fax : 01454 327983  
E-Mail : hcad@adlhighways.co.uk

ADL Job No. 4353

Project: A415 Ducklington Lane  
Witney

Title: TRO Plan  
Extension of 30mph zone

Date: 17.10.19 Drawn: MT

Checked	Date	Approved	Date

Scale: 1:250@A3 Drg No. 4353-300 Rev. -

This page is intentionally left blank



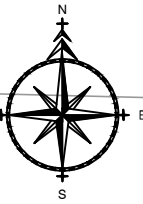

© Copyright ADL Traffic & Highways Engineering Ltd

NOTES

- 1. Do not scale from this drawing
  - 2. All details to be confirmed on site.
  - 3. Background plan is based upon a topographical survey supplied by greenhatch group and architects site plan supplied by DDP.
- Drawing No. 191 - 100 Rev. A.

PROHIBIT RIGHT TURNS FROM SITE EGRESS. VEHICULAR TRAFFIC MUST TURN AHEAD IN THE DIRECTION INDICATED BY THE ARROW.

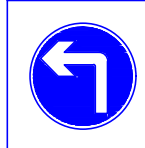

Rev	Description	Date	By	Chk

AMENDMENTS



ADL Traffic & Highways Engineering Ltd.  
 ADL House  
 The Oaklands Business Park  
 Yate, Bristol  
 BS37 5NA  
 Tel : 01454 332100  
 Fax : 01454 327983  
 E-Mail : hcad@adlhighways.co.uk

ADL Job No. **4353**

Project **A415 Ducklington Lane Witney**

Title **TRO Plan Prohibit right turns**

Date **17.10.19** Drawn **MT**

Checked	Date	Approved	Date

Scale	Org No.	Rev.
1:250@A3	4353-301	-

This page is intentionally left blank



**OXFORDSHIRE COUNTY COUNCIL  
(WITNEY, DUCKLINGTON LANE)  
(PROHIBITION OF RIGHT TURN) ORDER 20\*\***

Oxfordshire County Council (“the Council”) in exercise of its powers under Sections 1(1), 2(1) & (2) of the Road Traffic Regulation Act 1984 (“the Act”) and of all other enabling powers, and after consultation with the Chief Officer of Police in accordance with Part III of Schedule 9 to the Act hereby make the following Order.

This Order may be cited as the Oxfordshire County Council (Witney, Ducklington Lane) (Prohibition of Right Turn) Order 20\*\* and shall come into force on the            day of            20\*\*.

1. Save as provided by article 2 of this Order no person shall, other than under the direction of a police constable in uniform, cause or permit a vehicle to make a right turn northwards onto the A415 Ducklington Lane from (*site to be named later*) land on the east side of said road between Ducklington roundabout and the A40 overbridge (“the Section of Road”).
  
2. Nothing in article 1 to this Order shall render it unlawful for a person to cause or permit a vehicle to enter the Section of Road northwards if the vehicle is being used for Police, fire or ambulance services in an emergency;

**GIVEN UNDER** the Common Seal of the Oxfordshire County Council  
this            day of            20\*\*.

**THE COMMON SEAL** of **THE**  
**OXFORDSHIRE COUNTY COUNCIL**  
was affixed in the presence of:

Director of Law & Governance / Designated Officer

This page is intentionally left blank

**OXFORDSHIRE COUNTY COUNCIL  
(WITNEY AREA) (SPEED LIMITS) ORDER 20\*\***

The Oxfordshire County Council, in exercise of its powers under Section 84 and Part IV of Schedule 9 to the Road Traffic Regulation Act 1984 (“the Act”) and of all other enabling powers, and after consultation with the chief officer of police in accordance with Part III of Schedule 9 to the Act, hereby make the following Order.

1. This Order may be cited as the Oxfordshire County Council (Witney Area) (Speed Limits) Order 20\*\* and shall come into force on the                    day of                    20\*\*.
2. No person shall drive any motor vehicle at a speed exceeding 30 miles per hour in any of the lengths of road specified in Schedule 1 to this Order.
3. No person shall drive any motor vehicle at a speed exceeding 40 miles per hour in any of the lengths of road specified in Schedule 2 to this Order.
4. No person shall drive any motor vehicle at a speed exceeding 50 miles per hour in any of the lengths of road specified in Schedule 3 to this Order.
5. No speed limit imposed by this Order applies to a vehicle falling within Regulation 3(4) of the Road Traffic Exemptions (Special Forces) (Variation and Amendment) Regulations 2011, being a vehicle used for naval, military or air force purposes, when used in accordance with regulation 3(5) of those regulations.
6. The Oxfordshire County Council (Oxfordshire County Council (Witney Area) (Speed Limits) Order 2018 is hereby revoked.

**GIVEN UNDER the Common Seal of the Oxfordshire County Council**  
this                    day of                    20\*\*.

**SCHEDULE 1**

**30mph speed limit:**

The whole length of every road in Witney (except those roads and sections of road listed in Schedule 2) extending, in the case of the respective roads leading out of the town, to the following points:

a)	A4095 Curbridge Road	125 metres southwest of its junction with Deer Park Road
b)	B4047 Burford Road	55 metres west of its junction with Tower Hill
c)	Crawley Road.	222 metres northwest of its junction with Quarry Road
d)	Hailey Road	222 metres northwest of its junction with Eastfield Road (partly in the parish of Hailey)

e)	New Yatt Road	182 metres northeast of its junction with Early Road	
f)	Oxford Hill	50 metres southeast of its junction with Cogges Hill Road	
g)	Stanton Harcourt Road	30 metres south of its junction with Manor Road	
h)	Woodstock Road A4095	288 metres northeast of its junction with Harvest Way	
i)	Ducklington Lane, A415	A point <b>315 30 metres</b> north of its junction with Ducklington roundabout	
j)	Thorney Leys	to a point 89 metres west of its junction with Ducklington Lane.	
and			
k)	Downs Road	from its junction with the B4047 Burford Road, southwards	for a distance of 1040 metres.

## **SCHEDULE 2**

### 40mph speed limit:

1.	Book Ends	for its entire length.	
2.	B4047 Burford Road	from a point 55 metres west of its junction with Tower Hill, westwards	to a point 411 metres west of its junction with Downs Road - partly in the Parish of Curbridge.
3.	Deer Park Road	for its entire length.	
4.	A415 Ducklington Lane	from a point 30 metres north of the Ducklington roundabout <del>315 metres south of its junction with Station Lane,</del> southwards.	for a distance of <b>226 199 metres</b> , partly in the Parish of Ducklington
5.	Range Road	for its entire length.	
6.	Thorney Leys	from a point 540 metres southeast of its junction with the A4095 Curbridge Road, eastwards	to a point 89 metres southwest of its junction with Ducklington Lane.
7.	A4095 Witney to Woodstock road	from a point 50 metres southwest of its junction with Park Road, North Leigh, north-eastwards	to a point 380 metres northeast of its junction with Park Road, North Leigh.

8.	A4095 Curbridge Road	from a point 125 metres southwest of its junction with Deer Park Road, south-westwards	for a distance of 250 metres.
9.	Downs Road	from a point 1040 metres south of its junction with the B4047 Burford Road, southwards	to its junction with Main Road (partly in the parish of Curbridge)
10.	Downs Road / A40 Link Roads	from their roundabout junction with Downs Road (including its circulatory lanes), south-eastwards	to its roundabout junction with the A40

### **SCHEDULE 3**

#### **50mph speed limit:**

The A4095 Witney to Woodstock road within the Parishes of Witney and North Leigh:		
A4095 Witney Road	a) from a point 288 metres northeast of its junction with Harvest Way, Witney (the terminal point of the existing 30mph limit), north-eastwards	to a point 50 metres southwest of its junction with Park Road, North Leigh
	b) from a point 380 metres northeast of its junction with Park Road, North Leigh, north-eastwards	to a point 117 metres northeast of its junction with Cuckoo Lane, North Leigh (the terminal point of the existing 40mph speed limit) a distance of approximately 4150 metres.
Jubilee Way, Witney	from its junction with Woodstock Road, Witney, southwards	to its junction with Oxford Hill, Witney, approximately 1650 metres.

The A40 Witney Bypass in the Parish of Witney:		
A40 dual carriageway	from a point 326 metres west of the centre of Downs Road overbridge, eastwards (including the roundabout circulatory lanes)	to a point 489 metres east of the centre of Downs Road overbridge.

**THE COMMON SEAL of THE  
OXFORDSHIRE COUNTY COUNCIL**

was hereunto affixed in the presence of:

Director of Law & Governance / Designated Officer

This page is intentionally left blank

**OXFORDSHIRE COUNTY COUNCIL**  
**1. (WITNEY AREA) (SPEED LIMITS) ORDER 20\*\***  
**2. (WITNEY, DUCKLINGTON LANE) (PROHIBITION OF**  
**RIGHT TURN) ORDER 20\*\***

NOTICE IS HEREBY GIVEN that Oxfordshire County Council proposes to make the above orders under the Road Traffic Regulation Act 1984 and all other enabling powers. The effect of the orders, in response to local development and for road safety reasons is as follows:

- 1) To extend the 30mph speed limit on Ducklington Lane southwards to near Ducklington roundabout in place of the current 40mph; and
  - 2) To make a prohibition of right turn onto Ducklington Lane from the proposed development on the east side of the A415 south of the A40 overbridge, ensuring that exiting vehicles turn left only to the roundabout.
- The Oxfordshire County Council (Witney Area) (Speed Limits) Order 2018 will be revoked/replaced.

A copy of the proposed orders and all detailed documents may be inspected online by visiting: <https://consultations.oxfordshire.gov.uk>, or in person at County Hall, New Road, Oxford, OX1 1ND between 9am and 4.30pm Monday to Friday; and at WODC Town Centre Shop, 3 Welch Way, Witney, OX28 6JH, from 9am to 5.30pm Monday to Thursday, and 9am to 5pm on Fridays.

Objections to the proposals, specifying the grounds on which they are made and any other representations, may be sent in writing to the address below (or via the web address above) no later than **31 December 2019**. The Council will consider objections and representations received in response to this Notice. They may be disseminated widely for these purposes and made available to the public.

Traffic Regulation Team (Ref: JaC.12.6.410) for the Director of Community Operations, County Hall, Oxfordshire County Council, New Road, Oxford, OX1 1ND.



This page is intentionally left blank



# OXFORDSHIRE COUNTY COUNCIL

- OXFORDSHIRE COUNTY COUNCIL**  
**1. (WITNEY AREA) (SPEED LIMITS) ORDER 20\*\***  
**2. (WITNEY, DUCKLINGTON LANE) (PROHIBITION OF  
RIGHT TURN) ORDER 20\*\***

## **STATEMENT OF REASONS**

As a result of the development of land adjacent to the A415 Ducklington Lane, south of Witney, the County Council is proposing, for road safety reasons, to extend the 30mph limit on the Ducklington Lane, southwards, by approximately 27 metres, reducing the existing 40mph speed limit by the same amount.

It is also proposed to introduce a “No Right Turn” prohibition (i.e. only left turns permitted) for traffic entering the A415 Ducklington Lane, from the site exit road.

The Oxfordshire County Council (Witney area) (Speed Limits) Order 2018 will be revoked / replaced as required.

The County Council continues its responsibility to consider the provision of convenient and safe movement of motor vehicles and other traffic, and the proposed measure is aimed at ensuring that <sup>1</sup> danger is minimised whilst <sup>2</sup> facilitating the effective and safe passage of traffic.

Detailed documents accompany this form.

Date: 27<sup>th</sup> November 2019

Traffic Regulation Team, for the  
Director for Infrastructure Delivery,  
Oxfordshire County Council,  
County Hall  
New Road,  
Oxford  
OX1 1ND.

---

<sup>1</sup> Section 1 (1) (a) Road Traffic Regulation Act 1984

<sup>2</sup> Section 1 (1) (c) Road Traffic Regulation Act 1984

This page is intentionally left blank